

# 2.54mm(.100") DIP IC SOCKET



## 3000 SERIES. Dual In Line

### Features

- Available in 6, 8, 14, 16, 18, 20, 22, 24, 28, 32, 40, and 48 circuits
- Dual contact terminal in Phosphor Bronze
- Insulator Material: Glass filled polyester UL 94V-0
- Anti solder wicking
- Low profile

### Dimensional Information

### Ordering and Dimensional Information

Circuit Size	Part Number	Dimensions			
		A	B	C	D
6	3000 - 2061	5.08 (0.200)	7.50 (0.295)	9.90 (0.390)	7.62 (0.300)
8	3000 - 2081	7.62 (0.300)	10.00 (0.394)	9.90 (0.390)	7.62 (0.300)
14	3000 - 2141	15.24 (0.600)	17.60 (0.693)	9.90 (0.390)	7.62 (0.300)
16	3000 - 2161	17.78 (0.700)	20.20 (0.795)	9.90 (0.390)	7.62 (0.300)
18	3000 - 2181	20.32 (0.800)	22.70 (0.894)	9.90 (0.390)	7.62 (0.300)
20	3000 - 2201	22.86 (0.900)	25.30 (0.996)	9.90 (0.390)	7.62 (0.300)
22	3000 - 2221	25.40 (1.100)	27.80 (1.094)	9.90 (0.390)	7.62 (0.300)
24	3000 - 2241	27.94 (1.100)	30.30 (1.193)	17.60 (0.693)	15.24 (0.600)
28	3000 - 2281	33.02 (1.300)	35.40 (1.394)	17.60 (0.693)	15.24 (0.600)
32	3000 - 2321	38.10 (1.500)	40.50 (1.594)	17.60 (0.693)	15.24 (0.600)
40	3000 - 2401	48.26 (1.900)	50.70 (1.996)	17.60 (0.693)	15.24 (0.600)
48	3000 - 2481	58.24 (2.300)	60.80 (2.394)	17.60 (0.693)	15.24 (0.600)

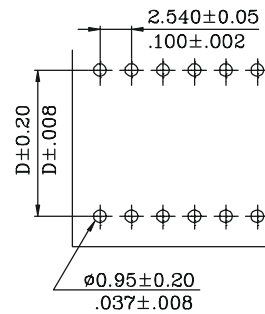
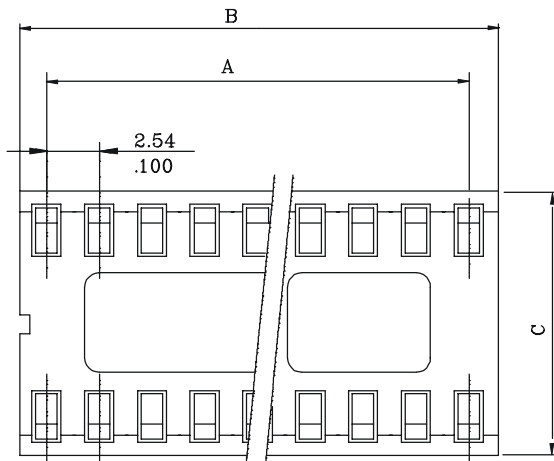

RECOMMENDED HOLE PATTERN

