

# 5.08mm SINGLE ROW RIGHT ANGLE HEADER



## 5088 SERIES. 5.08mm(0.200"). Square Pin. For PCB Solder

### Features

- Available in 1 through 20 circuits
- Insulator Material: Nylon 6/6 UL 94V-0
- 1.14mm(.045") square pin in tinned brass
- Easy breakaway to desired circuits
- Mates with 5080, 5081, 1507 and 1508 series headers
- With standoff minimise flux retention
- Pin omit options are available in any circuits
- Different pin lengths are available

### Dimensional Information

### Ordering and Dimensional Information

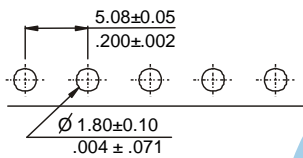
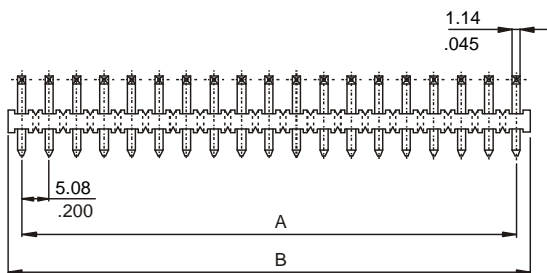
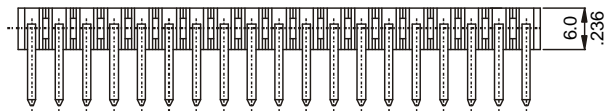

RECOMMENDED HOLE PATTERN

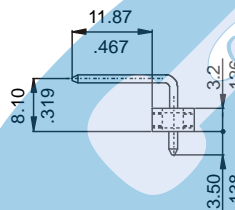

Circuit Size	Part Number	Dimensions	
		A	B
01	<b>5088-2011</b>	-	5.00 (0.196)
02	<b>5088-2021</b>	5,08(0,200)	10,16(0,400)
03	<b>5088-2031</b>	10,16(0,400)	15,24(0,600)
04	<b>5088-2041</b>	15,24(0,600)	20,32(0,800)
05	<b>5088-2051</b>	20,32(0,800)	25,40(1,000)
06	<b>5088-2061</b>	25,40(1,000)	30,48(1,200)
07	<b>5088-2071</b>	30,48(1,200)	35,56(1,400)
08	<b>5088-2081</b>	35,56(1,400)	40,64(1,600)
09	<b>5088-2091</b>	40,64(1,600)	45,72(1,800)
10	<b>5088-2101</b>	45,72(1,800)	50,80(2,000)
11	<b>5088-2111</b>	50,80(2,000)	55,88(2,200)
12	<b>5088-2121</b>	55,88(2,200)	60,96(2,400)
13	<b>5088-2131</b>	60,96(2,400)	66,04(2,600)
14	<b>5088-2141</b>	66,04(2,600)	71,12(2,800)
15	<b>5088-2151</b>	71,12(2,800)	76,20(3,000)
16	<b>5088-2161</b>	76,20(3,000)	81,28(3,200)
17	<b>5088-2171</b>	81,28(3,200)	86,36(3,400)
18	<b>5088-2181</b>	86,36(3,400)	91,44(3,600)
19	<b>5088-2191</b>	91,44(3,600)	96,52(3,800)
20	<b>5088-2201</b>	96,52(3,800)	101,60(4,000)

