

MULTI-PORT SIDE ENTRY PCB JACK FCC-68



6821 SERIES. For PCB Solder. Multi-Port Side Entry PCB Jack

Features

- Available in 6/2, 6/4, 6/6 and 8/8 circuits
- Mates with FCC-68 modular plugs
- Insulator Material: Glass filled polyester UL 94V-0
- Contacts: Golden phosphor bronze 0.45mm diameter
- Different plating options are available
- Gold plating over nickel in Contact Area.
- Tin plating over nickel in Solder Area
- Insulation resistance: 10 MΩ to 500 V AC
- Contact resistance: 20mΩ max.
- The number of ports is according to customer specifications

Dimensional Information

Ordering and Dimensional Information

Ports Number	Type			
	6/2 Version	6/4 Version	6/6 Version	8/8 Version
XX	6821 - T2XX	6820 - T4XX	6820 - T6XX	6820 - T8XX

T = Contact Plating

- T = 4. 6μ" gold over 50μ" nickel
- T = 5. 15μ" gold over 50μ" nickel
- T = 6. 30μ" gold over 50μ" nickel
- T = 7. 50μ" gold over 50μ" nickel

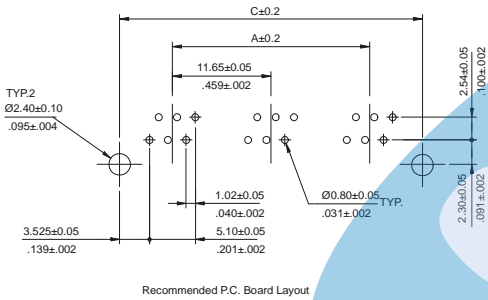
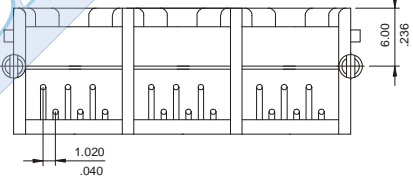
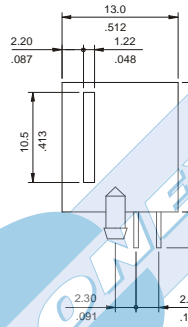
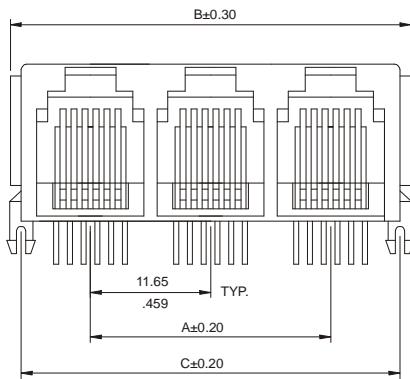

Recommended P.C. Board Layout

DIMENSIONS

- A = 11.65 x (P-1)
- B = 11.65 x P+2.50
- C = 11.65 x P+0.50

P = Number of ports (From 2 ports)

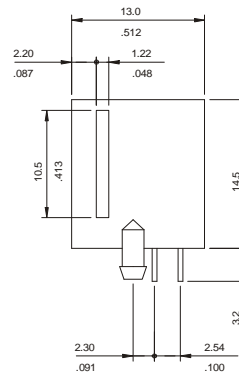
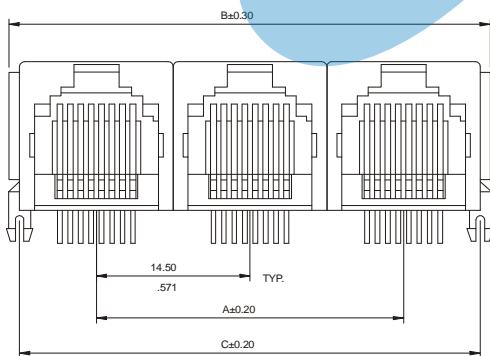

DIMENSIONS

- A = 14.50 x (P-1)
- B = 14.50 x P+3.00
- C = 14.50 x P+0.50

P = Number of ports (From 2 ports)

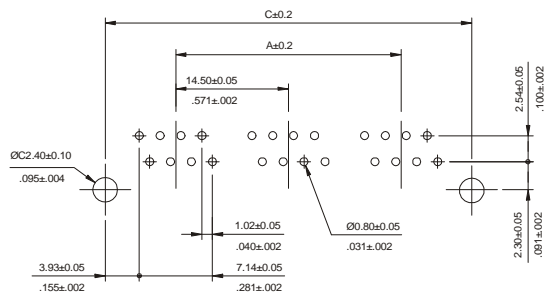
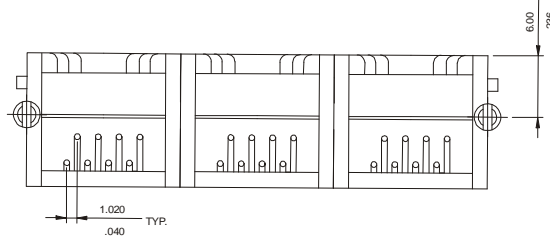

MECANIZADO RECOMENDADO