

TOP ENTRY PCB JACK FCC-68



7637 SERIES. For PCB Solder. Top Entry PCB Jack

Features

- Available in 6/4, 6/6 and 8/8 circuits
- Mates with FCC-68 modular plugs
- Insulator Material: Glass filled polyester UL 94V-0
- Contact: Square 0.35mm thickness
- Contacts: Golden phosphor bronze 0.35mm square
- Gold plating over nickel in Contact Area.
Tin plating over nickel in Solder Area

Dimensional Information

Ordering and Dimensional Information

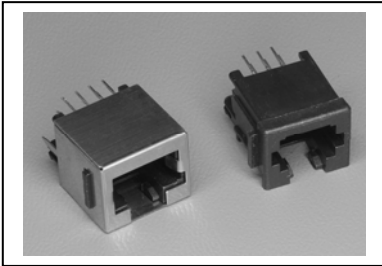

Circuit Size	Part Number		DIMENSIONES		
	W/O Panel stop	With Panel stop	A	B	C
6/4	7637 - T640	7637 - T641	17.80 (0.700)	11.43 (0.450)	3.81 (0.150)
6/6	7637 - T660	7637 - T661	17.80 (0.700)	11.43 (0.450)	6.35 (0.250)
8/8	7637 - T880	7637 - T881	17.80 (0.700)	11.43 (0.450)	8.89 (0.350)
8/8 (Polar.)	7637 - T883	7637 - T882	17.80 (0.700)	11.43 (0.450)	8.89 (0.350)
8/8 cat 5e	7637 - T884	7637 - T885	17.80 (0.700)	11.43 (0.450)	8.89 (0.350)

T = Contact Plating

- T = 4.6μ" gold over 50μ" nickel
- T = 5.15μ" gold over 50μ" nickel
- T = 6.30μ" gold over 50μ" nickel
- T = 7.50μ" gold over 50μ" nickel

Standard Version

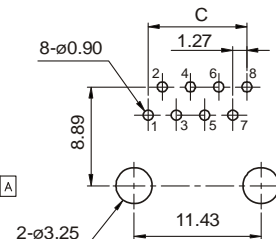
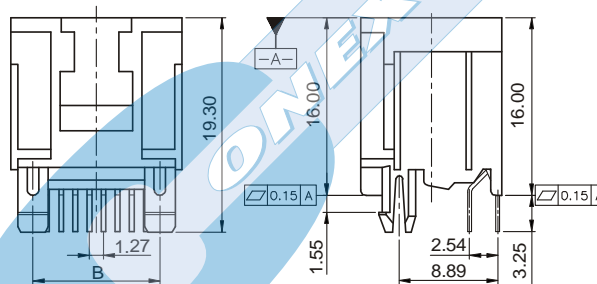
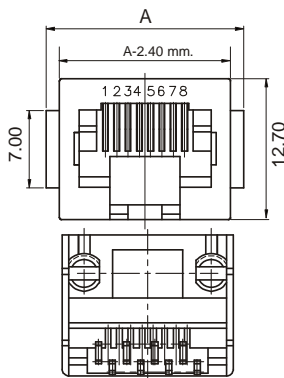

MECANIZADO RECOMENDADO
(Version estandar)

CAT. 5e Version

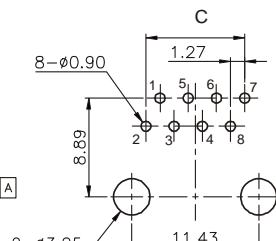
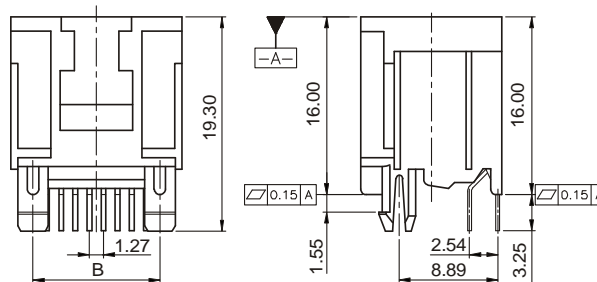
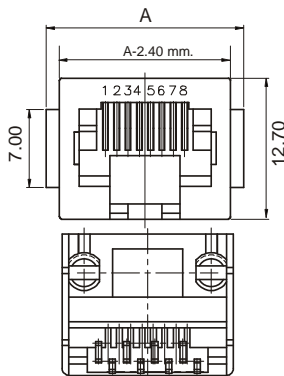

MECANIZADO RECOMENDADO
(Para conectores 5e)