

SINGLE IN LINE ADAPTER STRIP



8342 SERIES. 2.54mm(0.100"). For PCB Solder

Features

- Available in 2 through 40 circuits
- Insulation Material: PPS UL 94V-0
- Contact Material: Gold or tin plated brass per QQ-B-626
- Machined pin: Different pin length options available
- High reliability turned terminal with multiple finger contact
- For other options consult the Sales Office

Dimensional Information:

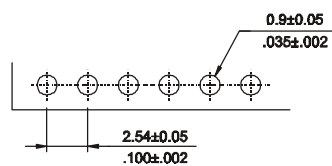
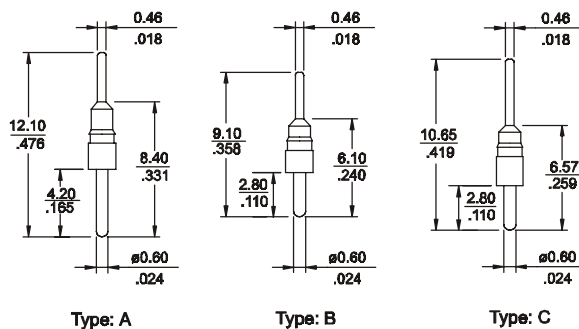
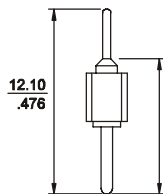
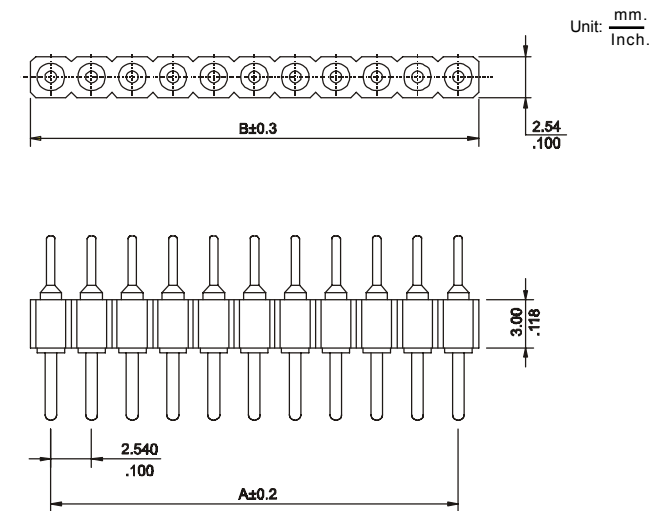

RECOMMENDED HOLE PATTERN

Ordering and Dimensional Information

Circuit Size	Part Number	Dimension	
		A	B
02	8342-T02X	2,54(0,100)	4,98(0,196)
03	8342-T03X	5,08(0,200)	7,52(0,296)
04	8342-T04X	7,62(0,300)	10,06(0,396)
05	8342-T05X	10,16(0,400)	12,60(0,496)
06	8342-T06X	12,70(0,500)	15,14(0,596)
07	8342-T07X	15,24(0,600)	17,68(0,696)
08	8342-T08X	17,78(0,700)	20,22(0,796)
09	8342-T09X	20,32(0,800)	22,76(0,896)
10	8342-T10X	22,86(0,900)	25,30(0,996)
11	8342-T11X	25,40(1,000)	27,84(1,096)
12	8342-T12X	27,94(1,100)	30,38(1,196)
13	8342-T13X	30,48(1,200)	32,92(1,296)
14	8342-T14X	33,02(1,300)	35,46(1,396)
15	8342-T15X	35,56(1,400)	38,00(1,496)
16	8342-T16X	38,10(1,500)	40,54(1,596)
17	8342-T17X	40,64(1,600)	43,08(1,696)
18	8342-T18X	43,18(1,700)	45,62(1,796)
19	8342-T19X	45,72(1,800)	48,16(1,896)
20	8342-T20X	48,26(1,900)	50,70(1,996)
21	8342-T21X	50,80(2,000)	53,24(2,096)
22	8342-T22X	53,34(2,100)	55,78(2,196)
23	8342-T23X	55,88(2,200)	58,32(2,296)
24	8342-T24X	58,42(2,300)	60,86(2,396)
25	8342-T25X	60,96(2,400)	63,40(2,496)
26	8342-T26X	63,50(2,500)	65,94(2,596)
27	8342-T27X	66,04(2,600)	68,48(2,696)
28	8342-T28X	68,58(2,700)	71,02(2,796)
29	8342-T29X	71,12(2,800)	73,56(2,896)
30	8342-T30X	73,66(2,900)	76,10(2,996)
31	8342-T31X	76,20(3,000)	78,64(3,096)
32	8342-T32X	78,74(3,100)	81,18(3,196)
33	8342-T33X	81,28(3,200)	83,72(3,296)
34	8342-T34X	83,82(3,300)	86,26(3,396)
35	8342-T35X	86,36(3,400)	88,80(3,496)
36	8342-T36X	88,90(3,500)	91,34(3,596)
37	8342-T37X	91,44(3,600)	93,88(3,696)
38	8342-T38X	93,98(3,700)	96,42(3,796)
39	8342-T39X	96,52(3,800)	98,96(3,896)
40	8342-T40X	99,06(3,900)	101,50(3,996)

T = Contact Plating

- T = 2. Tin plated
- T = 3. Gold flash over 50μ" nickel

Recommended Finish

- T = 4. 10μ" gold over 50μ" nickel
- T = 5. 15μ" gold over 50μ" nickel
- T = 6. 30μ" gold over 50μ" nickel

X = Pin Length

- X = 1. Type A
- X = 2. Type B
- X = 3. Type C